

## ◆CHIP TYPE TAPING SPECIFICATION

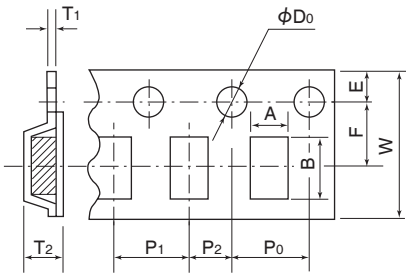

Type	Size Code	Dimensions (mm)										
		A*	B*	W ±0.3	F ±0.05	E ±0.1	P1 ±0.1	P2 ±0.05	P0 ±0.1	ϕD ±0.1	T1 max.	T2 max.
Chip type	31	1.9	3.5	8.0	3.5	1.75	4.0	2.0	4.0	1.5	0.6	1.5
	32	2.8	3.5	8.0	3.5	1.75	4.0	2.0	4.0	1.5	0.6	2.5
	43	3.65	4.95	12.0	5.5	1.75	8.0	2.0	4.0	1.5	0.6	3.5
	55	5.5	6.25	12.0	5.5	1.75	8.0	2.0	4.0	1.5	0.6	3.5
	76	6.85	8.05	16.0	7.5	1.75	12.0	2.0	4.0	1.5	0.6	5.5
Metal cap type	55	5.3	6.4	16.0	7.5	1.75	8.0	2.0	4.0	1.5	0.6	6.0
	76	6.9	8.2	16.0	7.5	1.75	12.0	2.0	4.0	1.5	0.6	7.5
		6.9	8.2	24.0	11.5	1.75	24.0	2.0	4.0	1.5	0.4	8.5
		6.9	8.2	32.0	14.2	1.75	24.0	2.0	4.0	1.5	0.5	10.0

\*Reference

## ●REEL SPECIFICATIONS

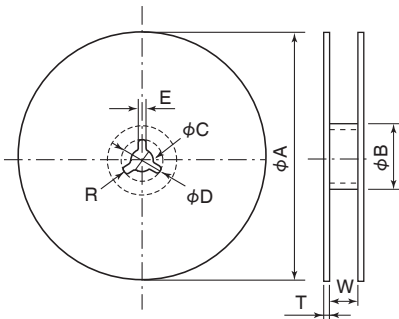

Size Code	Dimensions (mm)					
	NTS, NTF, KVF			NTJ, KVJ		
	31,32	43,55	76	55,76	76	
ϕA	180.0-3.0/+0	180.0-3.0/+0	180.0-3.0/+0	380.0±2.0	380.0±2.0	380.0±2.0
ϕB	60.0-0/+1.0	60.0-0/+1.0	60.0-0/+1.0	80.0±1.0	80.0±1.0	80.0±1.0
ϕC	13.0±0.2	13.0±0.2	13.0±0.2	13.0±0.2	13.0±0.2	13.0±0.2
ϕD	21.0±0.8	21.0±0.8	21.0±0.8	21.0±0.8	21.0±0.8	21.0±0.8
E	2.0±0.5	2.0±0.5	2.0±0.5	2.0±0.5	2.0±0.5	2.0±0.5
W	9.0-0/+1.0	13.0-0/+1.0	17.0-0/+1.0	17.4±1.0	25.4±1.0	33.4±1.0

NTS, NTF, KVF Series quantity per reel (pcs. / reel)

Size Code	31	32	43	55	76
Quantity	2000/3000	1600	800	800	300/500

Note : Refer to STANDARD RATINGS

NTJ, KVJ Series quantity per reel (pcs. / reel)

Size Code	55	76
Quantity	400/1500/2000	400/500/1200

Note : Refer to STANDARD RATINGS

## ◆RADIAL LEAD TYPE TAPING SPECIFICATION

### ●NTD, KVD Series

Available for 32, 43, 55, 76 sizes. Ammo Packaging.

Size Code	Dimensions H (mm)		Quantity per Packing (pcs.)
	Straight lead	Crimped lead	
32	23max.	25max.	2000
43	24max.	26max.	
55	26max.	28max.	
76	29max.	30max.	1000/1500

Note : Refer to STANDARD RATINGS

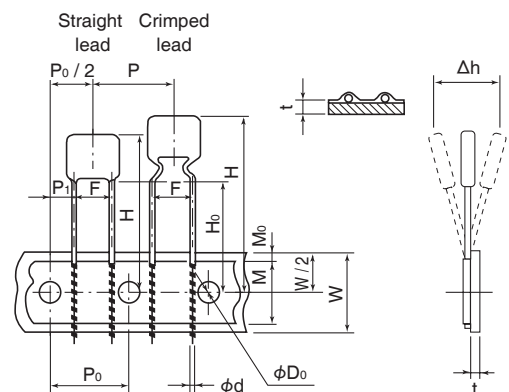

Code	P	P0	P1	P0/2	F	W	W/2	M	M0	H0	ϕD0	ϕd	t	Δh
Dimensions (mm)	12.7	12.7	3.85	6.35	5.0	18.0	9.0	13.0	1.5	16.0	4.0	0.5	0.6	0
	±1	±0.3	±0.7	±1.3	+0.8 -0.2	+1.0 -0.5	±0.5	±1	±1.5	min.	±0.2	±0.05	±0.2	±2